

**RIGHT ANGLE PCB RECEPTACLE
WITH HARPOON LEGS PACK160**

R214.670.320

Series : SMZ (BT43)

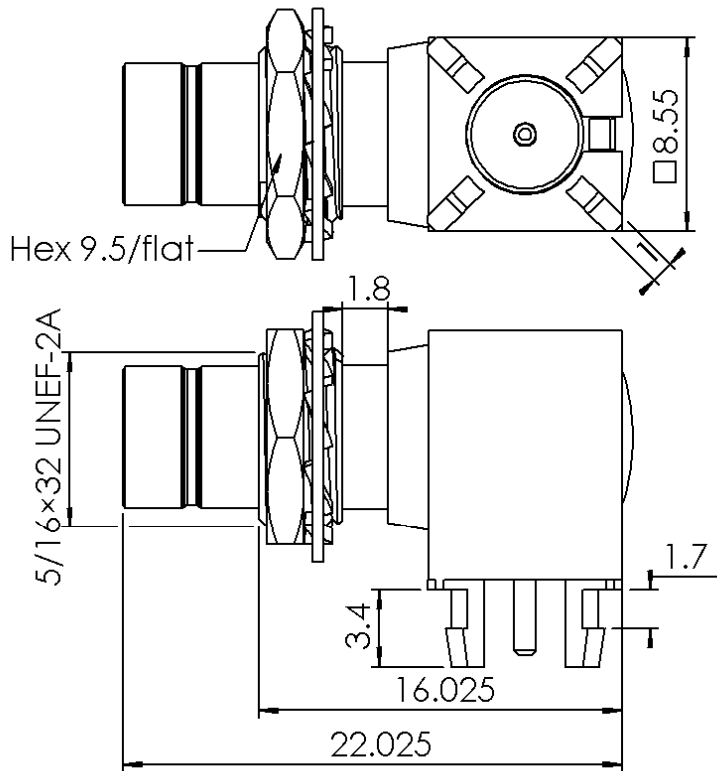

MOUNTING HOLE

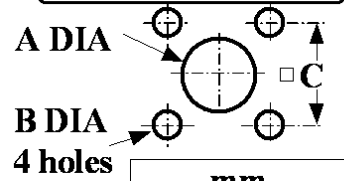

	mm	
	Maxi	mini
A	1.5	1.2
B	2.0	1.7
C	5.08	5.03

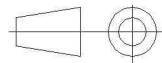
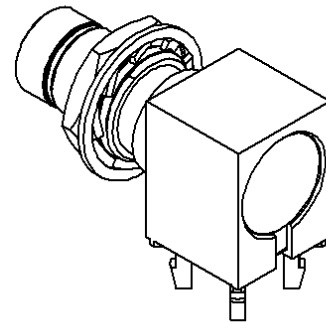
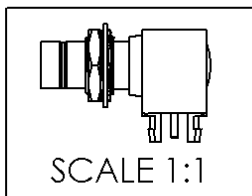

All dimensions are in mm.

COMPONENTS	MATERIALS	PLATING (µm)
BODY	BRASS	GOLD 1.5 OVER NICKEL 2
CENTER CONTACT	BRASS	GOLD 1.5 OVER COPPER 1.5
OUTER CONTACT		
INSULATOR	PTFE	
GASKET		
OTHERS PARTS	BRASS	NICKEL 2
-	-	-
-	-	-

Issue : 0533 A

In the effort to improve our products, we reserve the right to make changes judged to be necessary.



**RIGHT ANGLE PCB RECEPTACLE
WITH HARPOON LEGS PACK160**

R214.670.320

Series : SMZ (BT43)

PACKAGING

Standard	Unit	Other
160	'W' option	Contact us

SPECIFICATION

ELECTRICAL CHARACTERISTICS

Impedance		75 Ω
Frequency		0-3 GHz
VSWR	NA +	0,0000 x F(GHz) Maxi
Insertion loss		NA √F(GHz) dB Maxi
RF leakage	- (- F(GHz)) dB Maxi
Voltage rating		500 Veff Maxi
Dielectric withstanding voltage		1500 Veff mini
Insulation resistance		500 MΩ mini

ENVIRONMENTAL

Operating temperature	-40/+100 ° C
Hermetic seal	NA Atm.cm3/s
Panel leakage	NA

OTHER CHARACTERISTICS

Assembly instruction

Others :
Assembly nut and washer of R214.670.300

MECHANICAL CHARACTERISTICS

Center contact retention		
Axial force – Mating end	22	N mini
Axial force – Opposite end	NA	N mini
Torque	NA	N.cm mini
Recommended torque		
Mating	NA	N.cm
Panel nut	170	N.cm
Mating life	250	Cycles mini
Weight	1,8300	g

Issue : 0533 A

In the effort to improve our products, we reserve the right to make changes judged to be necessary.

